

SARGENT®

ASSA ABLOY

1331 Series

Door Closers



Table of Contents

1331 Series Door Closers

Features, Benefits & Applications	1
Standard & Parallel Applications.....	2
Top Jamb Application & Door Closer Operation.....	3
Accessories & ADA Compliance 	4
Architectural Specifications, How To Order & Packing	5

Any retrofit or other field modification to a fire rated opening can potentially impact the fire rating of the opening, and Sargent Manufacturing Company makes no representations or warranties concerning what such impact may be in any specific situation. When retrofitting any portion of an existing fire rated opening, or specifying and installing a new fire-rated opening, please consult with a code specialist or local code official (Authority Having Jurisdiction) to ensure compliance with all applicable codes and ratings.



SARGENT®

ASSA ABLOY



MicroShield®

As part of their promise to provide innovative solutions to their customers, certain ASSA ABLOY Group brands offer the MicroShield® technology, a silver-based antimicrobial coating designed to inhibit the growth of bacteria. MicroShield® is a registered trademark of Yale Security Inc., an ASSA ABLOY Group company.

MicroShield® Coating

- Revolutionary finish coating available on all SARGENT product lines, utilizes a silver-based antimicrobial compound from Agion Technologies
- As an integral part of the finish coating, MicroShield lasts for the life of the hardware
- MicroShield coating permanently suppresses the growth of bacteria, algae, fungus, mold and mildew. It is effective against a broad spectrum of bacteria.
- Non-toxic and completely safe. The Agion antimicrobial compound is EPA and NSF approved and FDA listed for use in medical and food preparation equipment.
- Applications: Anywhere there is need for a clean environment (hospitals, laboratories, schools, medical centers, daycare, food processing etc.)



Agion has achieved:



Agion's silver antimicrobial has been certified for its material content, recyclability, and manufacturing characteristics. Cradle To Cradle Certified^{CM} products meet established standards for human health, environmental health and recyclability.

Cradle To Cradle Certified^{CM} is a certification mark of MBDC.

ADA compliance



The 1331 Series is designed to meet the opening force requirements established by the Americans with Disabilities Act for 5 lbs. of opening force for interior doors. The spring power is fully adjustable. Where excessive draft and pressure conditions exist or when heavy doors are used, power will need to be adjusted to a stronger setting. Various field conditions (drafts) exist that make the use of ADA adjustments ineffective. When these conditions exist, refer to the 4000 Series Low Energy Operator.

On The Cover

- 1331 JO X EN

Features, Benefits & Applications

1331 Series Door Closers



SARGENT®

ASSA ABLOY

The SARGENT 1331 Series door closer is a Grade 1 fully adjustable closer suitable for new construction and also ideal for renovations.

Available with a selection of arms and accessories, the 1331 Series door closer can be used for most common applications and is ideal for standard duty installations. Common applications include offices, assisted living facilities, hotel guest rooms, public housing and retail establishments.

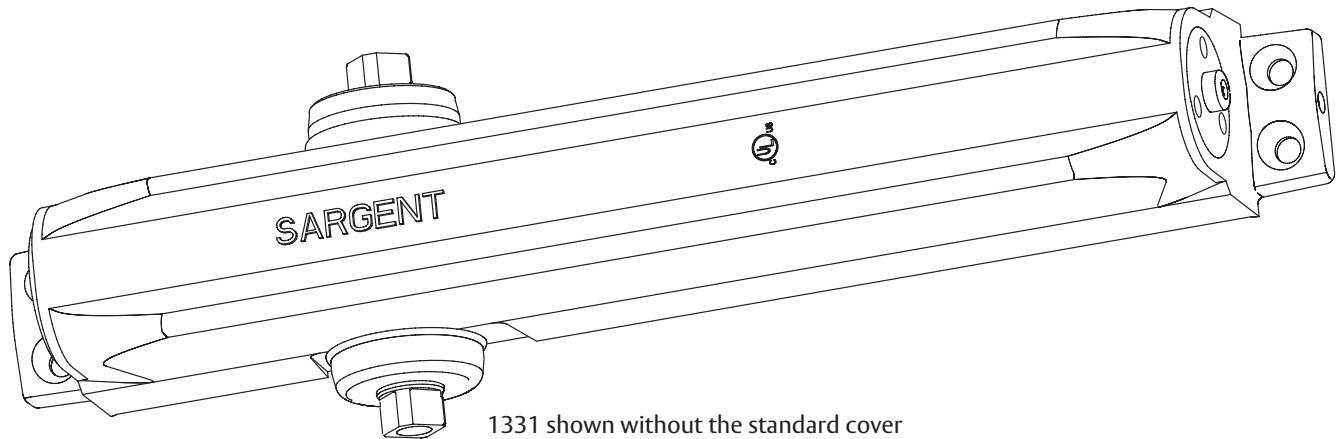

1331 shown without the standard cover

<p>Strength, Durability and Security</p> <ul style="list-style-type: none">• Meets and exceeds ANSI/BHMA A156.4 Grade 1 requirements• UL and UL 10C listed• Complies with ADA requirements and ANSI 111.7 and exterior doors• Adjustable closing force range from size 1 - 6• High impact full plastic cover secured by machine screws<ul style="list-style-type: none">- Optional ABS Cover available (consult factory for details)• One-piece high strength aluminum alloy body• 1-1/4" diameter piston for enhanced control• 7/16" square arm engagement for enhanced torque transmission• Heat treated rack & pinion provides longevity• Speed Control Valves<ul style="list-style-type: none">- Separate latching, closing/sweep and back check intensity valves- Captivated valves are easily adjusted using a standard 1/8" Allen wrench• Arms and accessories are powder-coated• 25 year limited warranty, body is date coded	<p>Convenience</p> <ul style="list-style-type: none">• Non-handed closer• All weather hydraulic fluid• Easily installed in minutes!• Easy-to-use instructions• Full size paper templates• Mortise nuts available when door condition requires through bolting, specify TB- option <p>Tri Pack or "Universal Packed" - JUO or JUH (Hold Open). Packages include one extra bracket that gives the installer a choice for installation from Standard, Parallel or Top Jamb applications.</p> <ul style="list-style-type: none">• When Tri-Pack is not required, specify application required, to receive the required arm <p>Flexibility</p> <ul style="list-style-type: none">• Retrofits a Dor-O-Matic SC 80 and Dorma 8600• Both machine and self-tapping screws provided• Universal body is interchangeable for all applications (standard, top jamb & parallel)• Designed for aluminum store front doors and frames• Similar design style to complement the Heavy Duty Powerglide Series• Allows door to open a full 180° (trim permitting)	<p>Applications</p> <ul style="list-style-type: none">• Office Buildings• Assisted Living Facilities• Hotel Guest Rooms• Public Housing• Retail Establishments <p>Innovation</p> <ul style="list-style-type: none">• SARGENT's revolutionary MicroShield® available. This antimicrobial silver-based finish coating permanently suppresses the growth of bacteria, algae, fungus, mold and mildew. EPA and NSF approved and FDA listed.
--------------------------------------------------------------------------------------------------------------------------------------------------------------------------------------------------------------------------------------------------------------------------------------------------------------------------------------------------------------------------------------------------------------------------------------------------------------------------------------------------------------------------------------------------------------------------------------------------------------------------------------------------------------------------------------------------------------------------------------------------------------------------------------------------------------------------------------------------------------------------------------------------------------------------------------------------------------------------------------------------------------------------------------------------------------------------------------------------------	------------------------------------------------------------------------------------------------------------------------------------------------------------------------------------------------------------------------------------------------------------------------------------------------------------------------------------------------------------------------------------------------------------------------------------------------------------------------------------------------------------------------------------------------------------------------------------------------------------------------------------------------------------------------------------------------------------------------------------------------------------------------------------------------------------------------------------------------------------------------------------------------------------------------------------------------------------------------------------------------------------------------------------------------------------------------------------------------------------------------------------------------------------------------------------------------------------	-----------------------------------------------------------------------------------------------------------------------------------------------------------------------------------------------------------------------------------------------------------------------------------------------------------------------------------------------------------------------------------------------------------------------------------------------------------------------------------------------------------------------

Standard and Parallel Applications

1331 Series Door Closers

SARGENT®

ASSA ABLOY



JO Standard Application, JH Hold Open (not shown)

The JO arm can be used on doors up to 48" wide and 160 lbs*. An auxiliary door stop is required. The JH hold open arm (not shown) is similar and allows for adjustable hold open from 75° to full opening.

The JO application (shown) is certified per ANSI A156.4 type C02011, including options PT4, A, B, C, D and H.

*** For doors heavier than 160 lbs., 1431 series closers should be used**

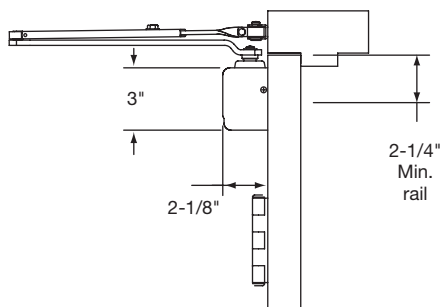
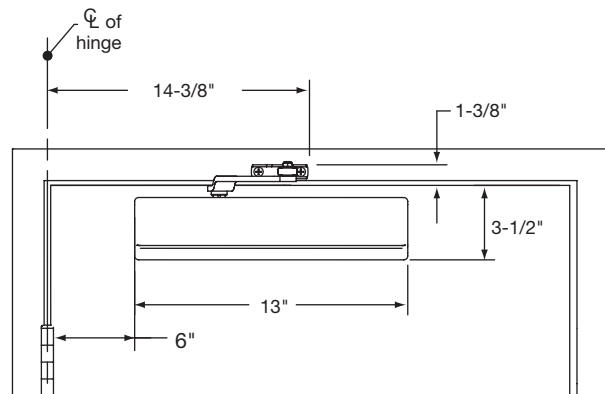
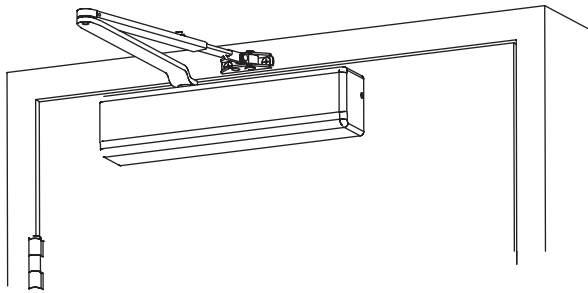

Closer shown templated for 120° max. opening

JP9 Parallel Arm Application, JPH9 Hold Open (not shown)

The JP9 arm can be used on doors up to 48" wide and 160 lbs*. An auxiliary door stop is required. The JPH9 hold open arm (not shown) is similar and allows for adjustable hold open from 75° to full opening.

The JP9 application (shown) is certified per ANSI A156.4 type C02021, including options PT4, A, B, C, D and H.

*** For doors heavier than 160 lbs., 11431 series closers should be used**

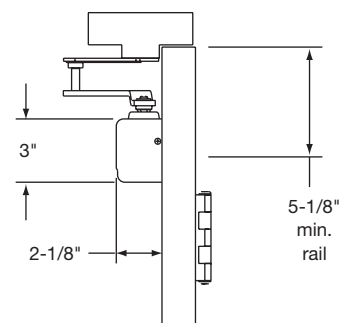
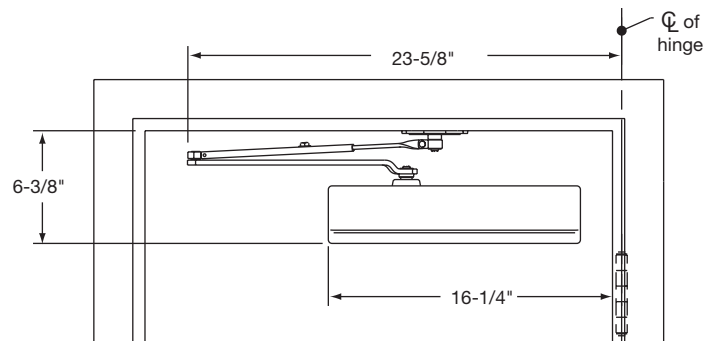
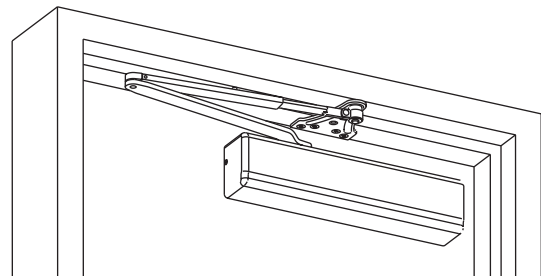

Closer shown templated for 120° max. opening

Copyright © 2004, 2007, 2009-2012, Sargent Manufacturing Company, an ASSA ABLOY Group company. All rights reserved. Reproduction in whole or in part without the express written permission of Sargent Manufacturing Company is prohibited.

90123HF 08/01/2012

Top Jamb Application & Door Closer Operation

1331 Series Door Closers



JO Top Jamb Application, JH Hold Open (not shown)

The JO arm can be used on doors up to 48" wide and 160 lbs* with reveals less than 3". An auxiliary door stop is required. The JH hold open arm (not shown) is similar and allows for adjustable hold open from 75° to full opening.

Maximum weight of 160 lbs.

The JO Top Jamb application (shown) is certified per ANSI A156.4 type C02041, including options PT4, A, B, C, D and H.

*** For doors heavier than 160 lbs., 1430 series closers should be used**

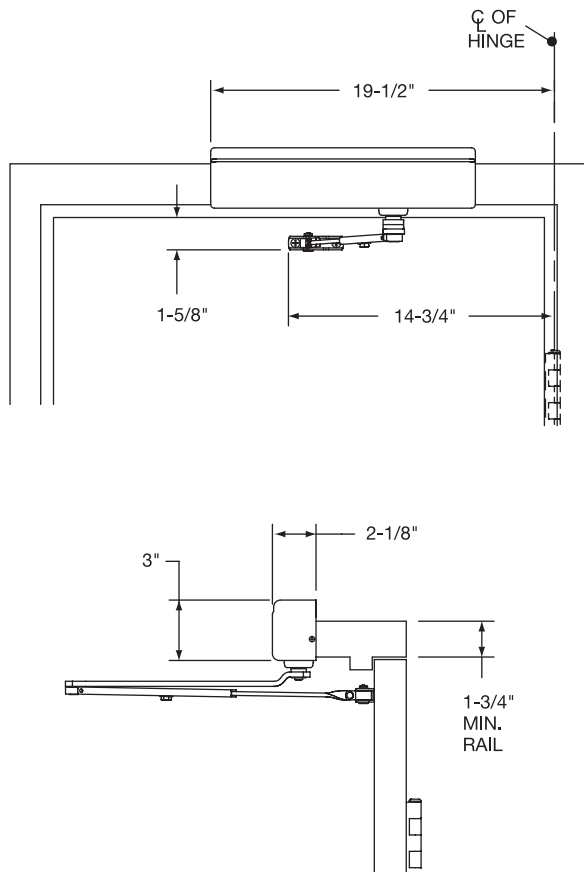
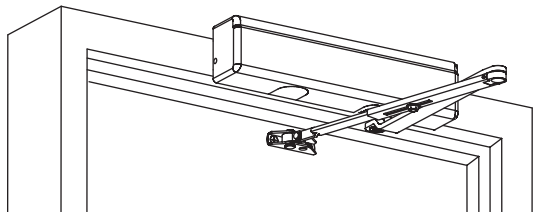

Closer shown templated for 120° max. opening

Door Closer Operation

1. When the door is opened, the arm rotates the spindle, compressing the spring and storing energy.
This "stored energy" will be released as the door closes.
2. Backcheck is a standard adjustable feature that adds resistance as the door is opened to at least 70°. This slows the door prior to making contact with a door stop at 90°. For doors that open more than 90°, backcheck can be easily turned off.
Backcheck should not be used as a door stop.
An auxiliary door is still required.
3. Closing or Sweep Speed allows you to adjust the time for the door to close from a fully open position to 2"-10" away from the closed position.
4. Latching Speed is one more valve to provide additional control of the door for the last few inches.

This additional control is sometimes needed to overcome interference such as latches, door coordinators, exit devices and weather stripping.

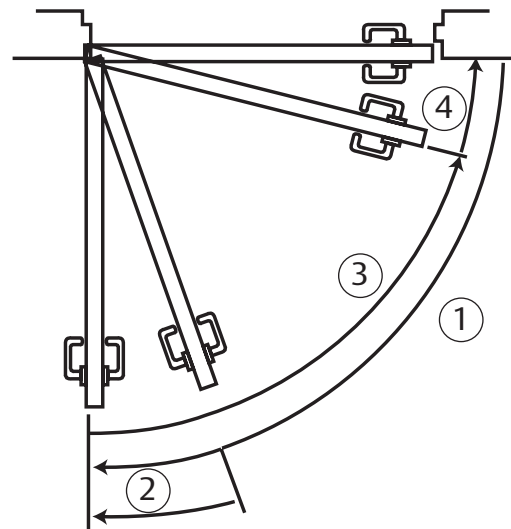

1. Opening Cycle
2. Backcheck
3. Closing/Sweep Cycle
4. Latching Cycle

Accessories and ADA Compliance

1331 Series Door Closers



Accessories

1331D Drop Plate Parallel Arm Application used with Narrow Top Rail

1331D Drop Plate is required when top rail is less than 5-1/8".
A minimum 3" top rail is required

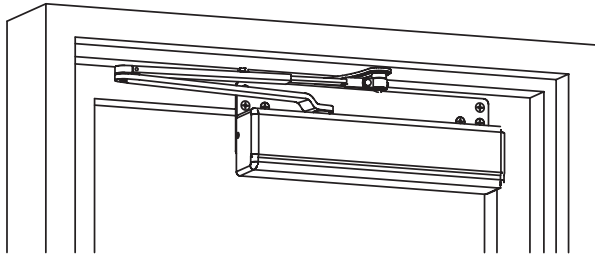

JP9 Arm shown with drop plate

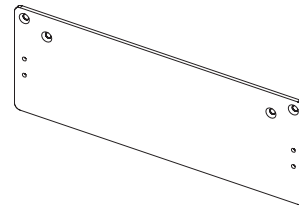

1331B Mounting Plate used on a narrow face frame

1331B Mounting Plate is required when frame face is less than 1-5/8".
A minimum 1-1/8" is required when Auxiliary Lock hardware such as overhead stops or door coordinators, etc. are used.

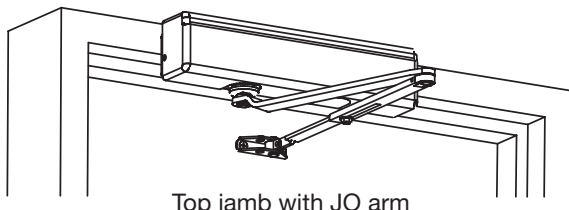

Top jamb with JO arm with B mounting plate

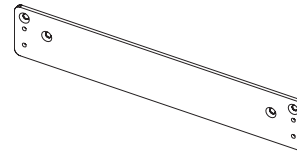

581-1 Blade Stop Kit

Kit includes longer fasteners and 1/2" thick metal spacer for use with 1/2" blade stops commonly found on store front aluminum frames.
Used with JP9 and JHP9 arms

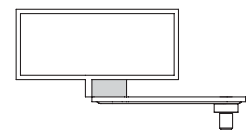
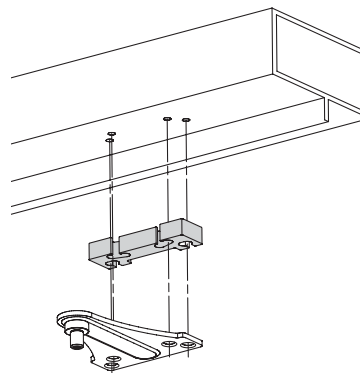

ADA compliance



The 1331 Series is designed to meet the opening force requirements established by the Americans with Disabilities Act for 5 lbs. of opening force for interior doors. The spring power is fully adjustable. Where excessive draft and pressure conditions exist or when heavy doors are used, power will need to be adjusted to a stronger setting. Various field conditions (drafts) exist that make the use of ADA adjustments ineffective. When these conditions exist, refer to the 4000 Series Low Energy Operator.

Copyright © 2004, 2007, 2009-2012, Sargent Manufacturing Company, an ASSA ABLOY Group company. All rights reserved. Reproduction in whole or in part without the express written permission of Sargent Manufacturing Company is prohibited.

90123HF 08/01/2012

Architectural Specifications, How To Order & Packing

1331 Series Door Closers

SARGENT®
ASSA ABLOY



Specifications

2.0 DOOR CLOSERS

- A. Door closers shall be 1331 Series as manufactured by Sargent Manufacturing Company, New Haven, CT.
- B. Door closers shall meet ANSI/BHMA A156.4, Grade 1 requirements.
- C. Door closers shall be UL listed (US and Canada) for use on fire doors.
- D. Door closer shall meet the requirements of UL 10C positive pressure fire tests.
- E. Provide closers adjustable from sizes 1 through 6.
- F. Closers shall be non-handed to meet a variety of door conditions and design requirements.
- G. Closing speed, latching speed and backcheck shall be controlled by separate key operated, captivated valves.
- H. Closers shall have heat treated rack and pinion construction.
- I. An increase of 15 percent in closing power shall be provided by means of adjustment of the arm leverage at the foot connection. (Standard Arm mount)
- J. Closer main arms shall be heavy duty steel with powder coated finish.
- K. Door closer bodies:
 - 1. One piece door closer body shall be of high strength aluminum alloy.
 - 2. Adjustment valves shall be captivated and non-critical.
 - 3. Closer spindle shaft shall be sealed hydraulically with an "O" ring.
- L. Projection of closer body from door shall not exceed 2-3/16" (56mm).
- M. Closer covers shall be constructed of high impact plastic material of flame retardant grade, secured by machine screws. Optional ABS covers available.
- N. Closer covers shall be of the same style/design of other closers specified for this project.
- O. Closers shall be suitable for standard, top jamb, and parallel arm type applications when provided with proper brackets and arms.
- P. Door closers shall have a 25 year limited warranty.

Packing

- Closer packaged 4 per carton

Series	Number per Carton	Approx. wt per Carton
1331	4-Standard	28 lbs. per 4

How To Order

		Example
Mortise Nuts	Used with machine screws standard, specify TB-	TB-
Series	1331	TB-1331
Arm	Arms available: JO, JP9, JH, JPH9, JUH, JUO	TB-1331 JUO
Finish	EB – Bronze Enamel to match 10B ED – Bronze Enamel to match 20D EN – Aluminum Enamel EP – Bronze Enamel to match US10 EAB – Brass Enamel to be used with brass finishes	TB-1331 JUO EB

Note: Specify 31- for doors 1-7/8" to 2-1/4" thick, specify door thickness, doors over 2-1/4" thick contact factory

How To Order Accessories

		Example
Arm Only (specify 25-)	Specify: 25- arm (JO, JP9, JH, JPH9) x finish	25-JO x EN
Cover (standard) only (specify -C)	Specify: 1331-C x finish	1331-C x EP
Body only (specify CB-)	Specify: CB-1331	CB-1331
ABS Cover (optional) only (specify -CEC)	Specify: 1331-CEC x finish	1331-CEC x EB
Drop Plate – For Parallel Arm	Specify: 1331D x finish	1331D x EP
Mounting Plate (Top Jamb)	Specify: 1331B x finish	1331B x ED
Parallel Arm Bracket	Specify: 125JP9 x finish	125JP9 x EAB (converts JO to JP9)
Parallel Arm Bracket	Specify: 125JPH9 x finish	125JPH9 x EN (converts JH to JPH9)
Complete Screw Pack	Specify: 61-2765	61-2765
Mortise Nuts	Specify: 4TB x finish	4TB x EB

Note: When complete closer assembly is ordered with an accessory, order accessory as a separate item.

SARGENT Manufacturing Company
100 Sargent Drive, New Haven, CT 06511 USA
800-727-5477 • www.sargentlock.com

Founded in the early 1800s, SARGENT® is a market leader in locksets, cylinders, door closers, exit devices, electro-mechanical products and access control systems for new construction, renovation, and replacement applications. The company's customer base includes commercial construction, institutional, and industrial markets.

Copyright © 2004, 2007, 2009-2012, Sargent Manufacturing Company, an ASSA ABLOY Group company. All rights reserved. Reproduction in whole or in part without the express written permission of Sargent Manufacturing Company is prohibited.

ASSA ABLOY is the global leader in door opening solutions, dedicated to satisfying end-user needs for security, safety and convenience.